

APPROVAL - CUSTOMER NAME & SIGNATURE

DATE

REV	DATE	DESCRIPTION	PART NUMBER
A	04MAY93	ALC PRN: S-1-03	F7-71
B	01NOV98	MSB PRN: P2002-0790	
C	19OCT00Z	AUT/DLH PRN: P2002-0790	

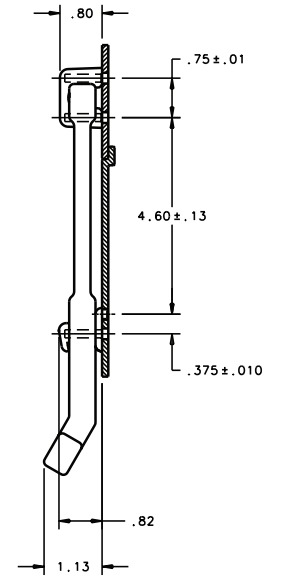
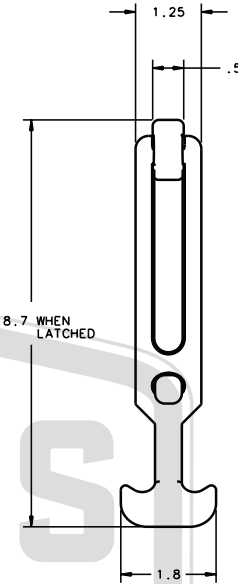
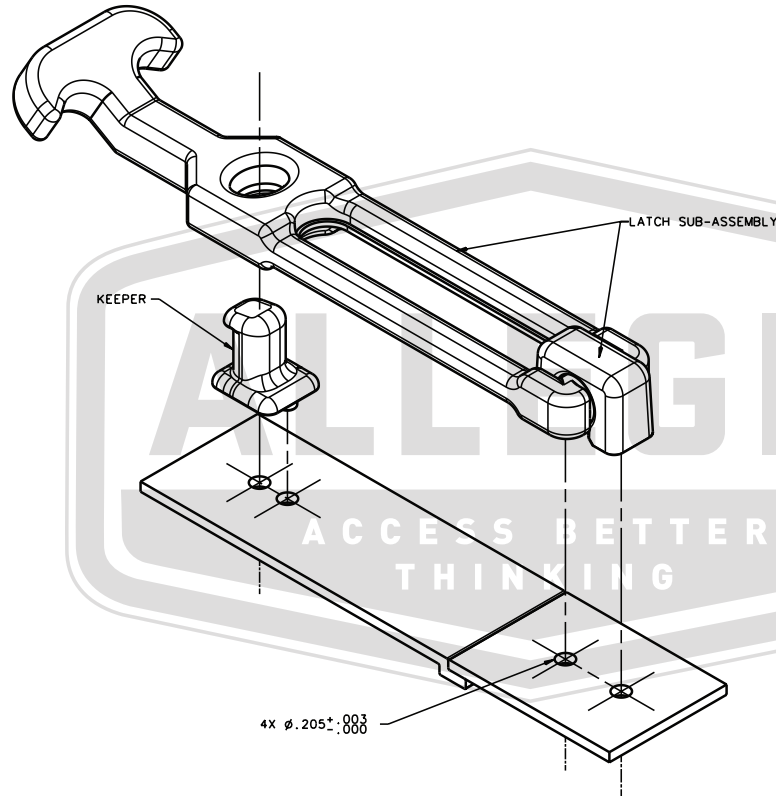

INSTALLED VIEWS
(SCALE .5:1)

- NOTES:
- LATCH ASSEMBLY CONSISTS OF:
SUB-ASSEMBLY:
HANDLE - TPE, BLACK
BRACKET - G.R. NYLON, BLACK.
KEEPER - G.R. NYLON, BLACK
 - LATCH SUB-ASSEMBLY, KEEPER, AND SCREWS SHIPPED SEPARATELY, BULK. FOR LATCHES PACKAGED ONE PER BAG, ADD -P TO PART NUMBER.
 - MOUNT USING (3) 10-24 THREAD SCREWS (NOT SUPPLIED).
SCREW LENGTH = PANEL THICKNESS PLUS .50.

ALLEGIS		1-866-378-7550
MATERIAL: Nylon, Rubber		DRAWING NO. : F7-71
FINISH: Natural		
REV.:	1:1	DATE: 5/29/2019